

Jennifer Newman | **Café table** indoor/outdoor use

All-welded, no assembly required.

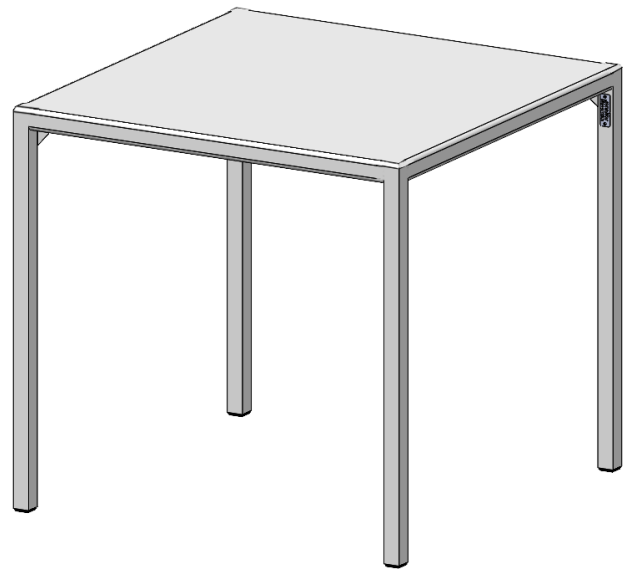

Seats 4
800w x 800d x 750h mm
Weight 18 kg

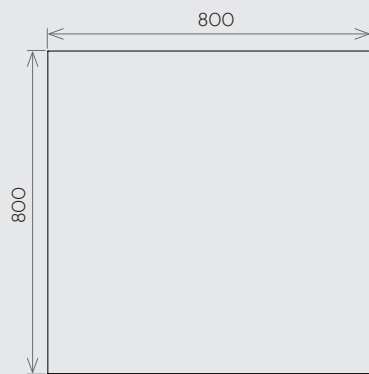

Seats 4

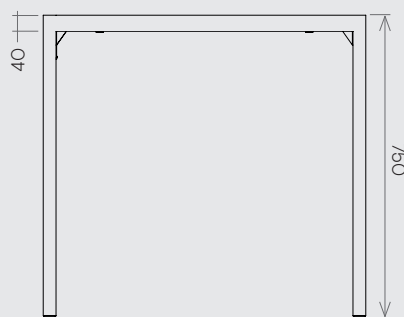

All dimensions are in mm.

- Aluminium for long-life, will not rust.
- Fine texture powder-coat resilient to wear and tear.
- Anti-bacterial and volatile-organic-compound (VOC) free.
- Low-glare surface reflection.
- Protective pads for stacking.
- Bolt-down brackets available.
- Minimal maintenance, easily cleaned.
- 10 standard colours, others on request (see separate reference sheet).